

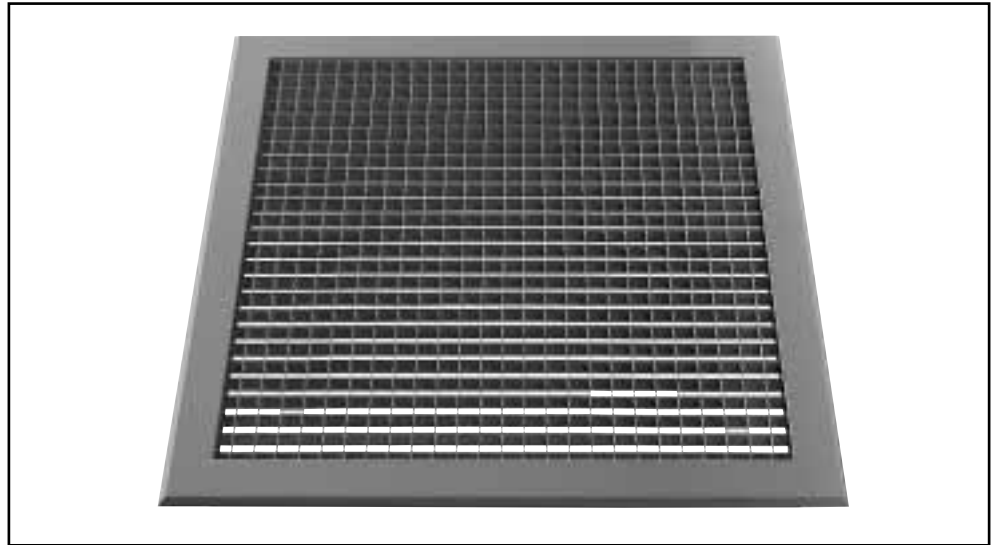

# EGG CRATE GRILLE 13mm

**1.32**  
AEC



## Selection Guide

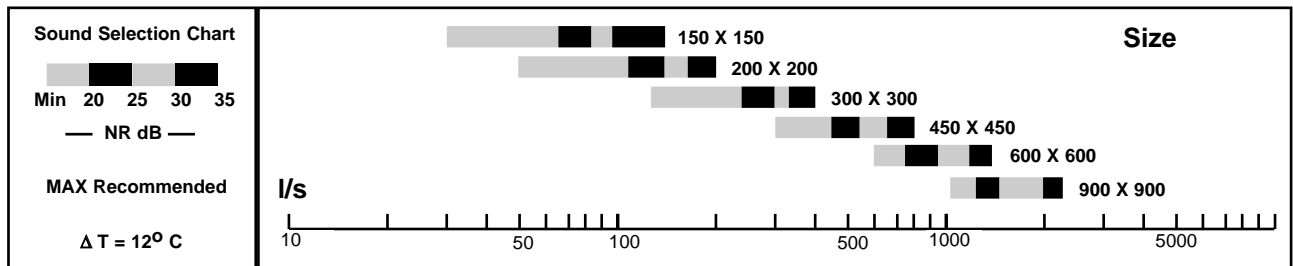

### Ordering procedure

Using the chart below select your requirement and substitute the underscored text below.

**Type..X..Y** (X & Y are the nominal neck sizes of the grille, see overleaf.)

**Example:** If your requirement is for a 18" x 24" (450 x 600) egg crate grille, hinged with a filter, the ordering code would be **AEHF1824**. {When ordering it is not necessary to include the periods [..]} Special sizes are available upon request. Contact your nearest Bradflo office.

Product Size Numbers														
"Type"	"X" Size	"Y" Size											Colour	
		6" (150)	8" (200)	10" (250)	12" (300)	14" (350)	16" (400)	18" (450)	20" (500)	24" (600)	28" (700)	36" (900)		40" (1000)
AECS (Ceiling Clip)	6" (150)													Powder coat white
AECS (Ceiling Clip)	8" (200)													
AECR (Removeable grille)	10" (250)													
AEHF (Hinged with filter)	12" (300)													
AEH (Hinged with no filter)	14" (350)													
AECRI (Removeable inner)	16" (400)													
AECR (Removeable grille)	18" (450)													
	20" (500)													Special colours
Special sizes	24" (600)													

# 1.32

AEC

## EGG CRATE GRILLE 13mm



### Description

The 1.32 (AEC) grilles are designed for use in exhaust or return air situations and may be mounted in walls or ceilings. They are not to be used for floor mounting.

The grilles have extruded aluminium frames with a 13mm x 13mm x 13mm aluminium egg crate core. Hinged models are available as standard and provide easy access to filters or other equipment. Grilles up to 600mm x 600mm are available with spring retaining clip for fast and efficient mounting in ceilings.

The free area of the grille is >90% of the nominal area, providing maximum air flow and very low noise levels.

### Finish

Standard finish is white electrostatic powdercoat. There are also 15 other colours to choose from at no additional cost.

Contact your local Bradflo branch for any special requirement you may have.

### Design dimensions

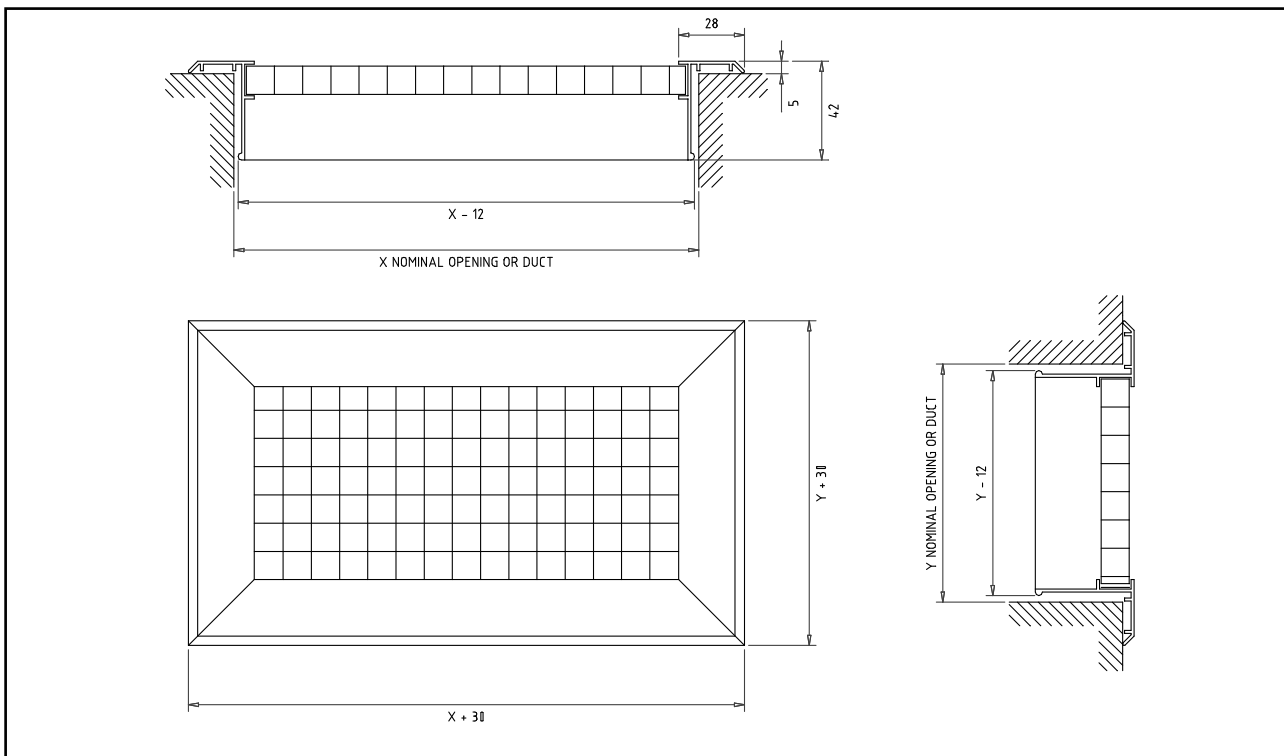



# EGG CRATE GRILLE 13mm

**1.32**  
AEC

### Air Filtration

A filter is offered as a standard option in removable and hinged core grilles. This filter is easily removed for cleaning, easy access or replacement.

### General Description

The filter media is manufactured in a synthetic non-woven material. It offers low air resistance, long life and satisfactory dust extraction efficiency with particular emphasis on the collection of fluff, linters and pollens.

### Physical Properties of filter material

#### Performance

When tested to AS1132-1973 methods 2 and 4 (Report No. 1558/95), the following results were obtained.

Initial resistance at 1.8 m/s was 35 Pa  
When loaded to a final resistance of 250 Pa the average resistance was found to be 85.3% and the dust holding capacity 411 g/m<sup>2</sup>.

Note! AS1132 method 4 uses test dust #4.

### Sound data

NR levels for the grille may be determined from the engineering graph.

### Sound power level $L_w$

The generated sound power level  $L_w$  dB is calculated by adding the correction factor  $K_{Ok}$  (see table below) to the sound level NR dB according to the formula:

$$L_w = NR + K_{Ok}$$

Size	Frequency (cycles per second)						
	125	250	500	1000	2000	4000	8000
All	+14	+14	+6	-8	-5	-4	-8
Tol +/-	2	2	2	2	2	2	2

Correction factor  $K_{Ok}$

### Performance data

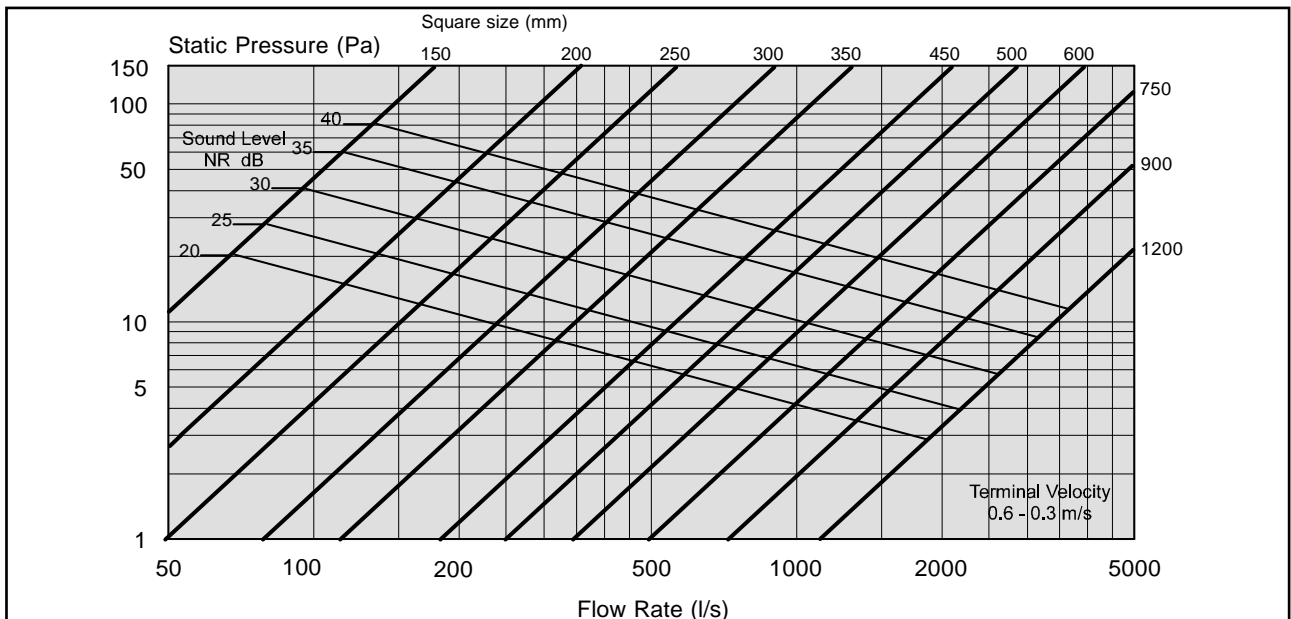

These graphs are for selection only and should not be used for commissioning.